

**Appendix 2.5 – Internal & External**  
**Internals from 22/03/2019 to 19/07/2019**  
**Externals from 20/05/2019 to 18/07/2019**

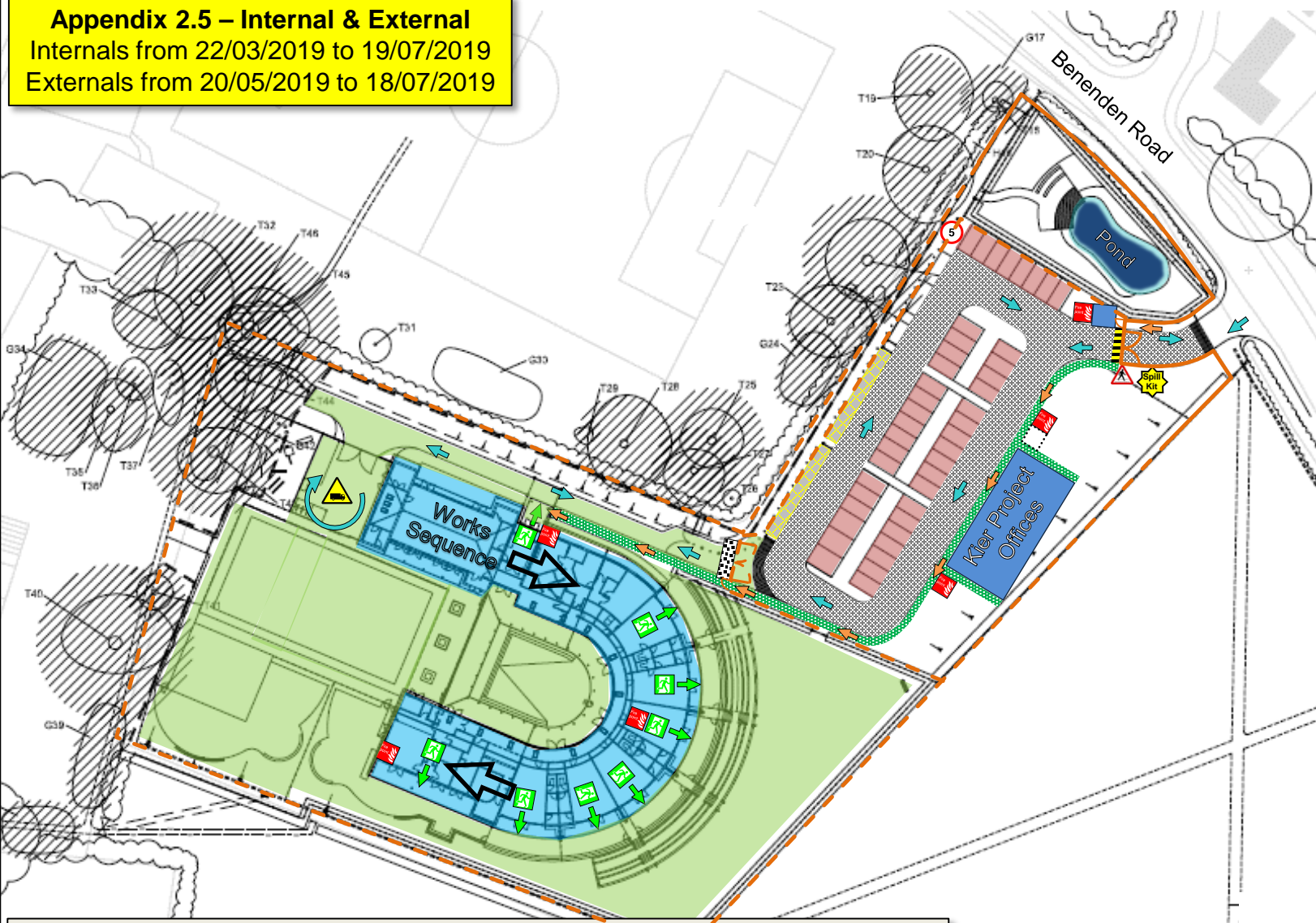

- = Project Offices
- = Site Pedestrian Route
- = Site Vehicle Route
- = Site Pedestrian Access to Works Area
- = Pedestrian Crossing Point
- = Site Speed Limit
- = First Aid (Available in Kier Project Offices)
- = Fire Exits (Must be kept clear at all times)
- = Spill Kit Locations
- = Moving Plant & Vehicles
- = Fire Points
- = Site Parking (43no)
- = Material Storage Areas
- = Wheel Wash



**Benenden C of E Primary School**

**Draft Proposed Site Wide Fire Plan & Traffic Plan**

Appendix 2.5 – Internal & External  
 Revision - Draft 23.05.18

**Activities**

**Internal Works Activities**

- Mechanical & electrical works, dry lining
- Underfloor heating, screed, carpentry
- Ceilings, decorations, floor finishes
- Kitchen fit out
- Snagging & final clean

**External Works Activities**

- Paving slabs.
- Tarmac.
- Plant trees, shrubs & grass seeding.
- Fencing installation.
- Construction of MUGA

**Received - 26 September 2018**  
**Planning Applications Group**