

Appendix 2.2 - Substructure Period
From 05/11/2018 to 08/02/2019

Received - 26 September 2018
Planning Applications Group

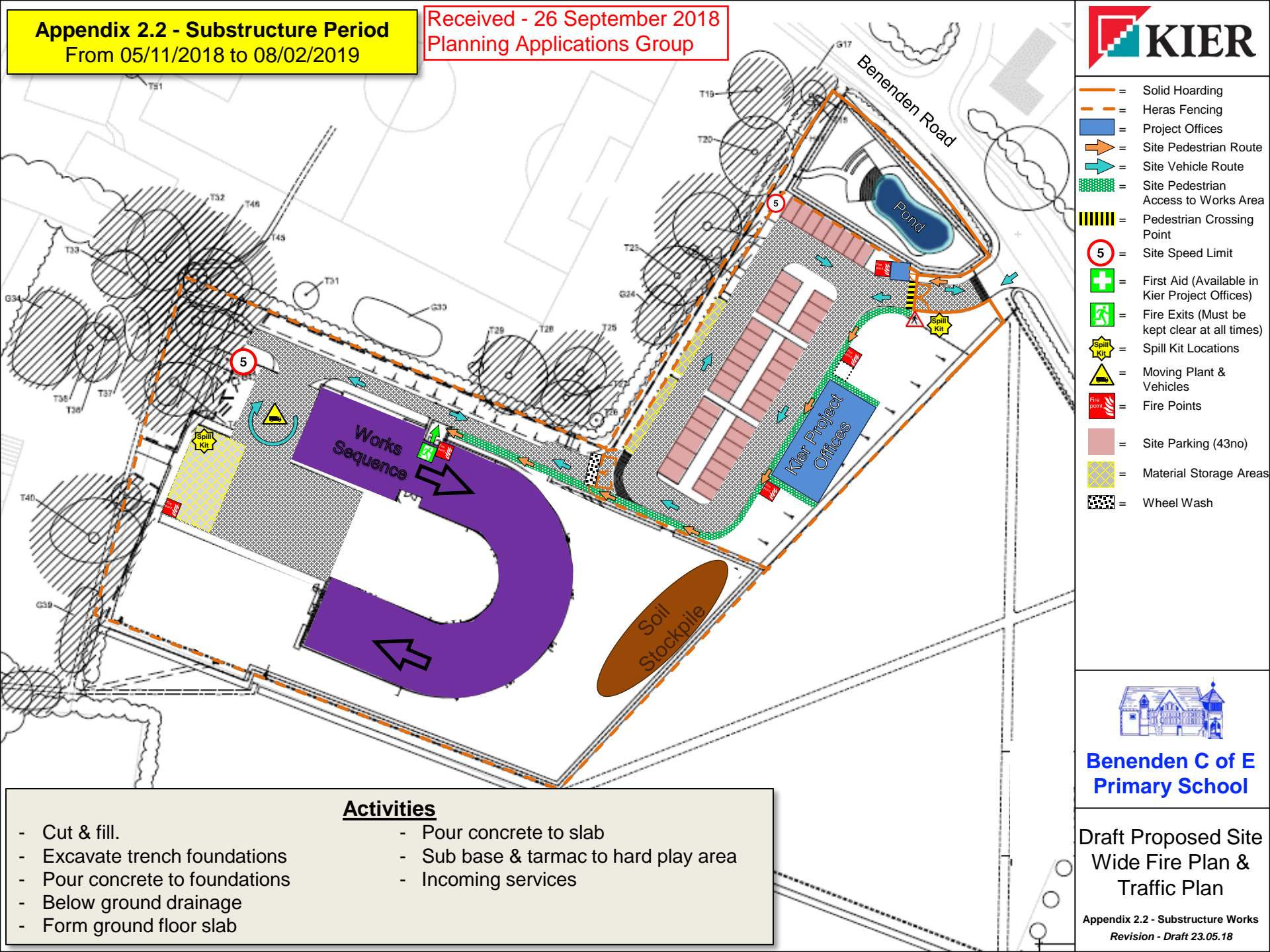

- = Solid Hoarding
- = Heras Fencing
- = Project Offices
- = Site Pedestrian Route
- = Site Vehicle Route
- = Site Pedestrian Access to Works Area
- = Pedestrian Crossing Point
- = Site Speed Limit
- = First Aid (Available in Kier Project Offices)
- = Fire Exits (Must be kept clear at all times)
- = Spill Kit Locations
- = Moving Plant & Vehicles
- = Fire Points
- = Site Parking (43no)
- = Material Storage Areas
- = Wheel Wash



**Benenden C of E
Primary School**

**Draft Proposed Site
Wide Fire Plan &
Traffic Plan**

Appendix 2.2 - Substructure Works
Revision - Draft 23.05.18

Activities

- Cut & fill.
- Excavate trench foundations
- Pour concrete to foundations
- Below ground drainage
- Form ground floor slab
- Pour concrete to slab
- Sub base & tarmac to hard play area
- Incoming services